

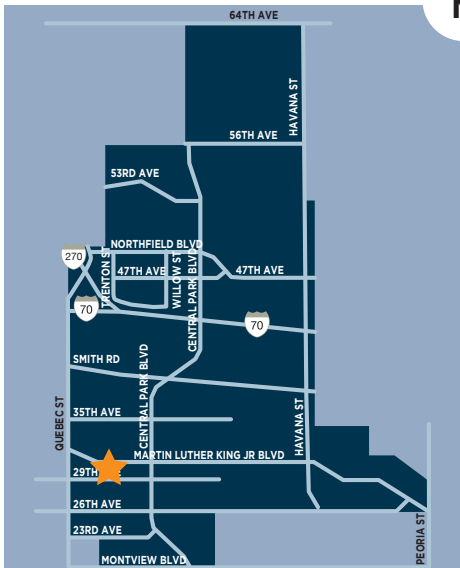

Stapleton BUSINESS Ready

3055 ROSLYN STREET

AVAILABLE FOR LEASE



Stapleton **BUSINESS** Ready

3055 ROSLYN STREET ■ DENVER, COLORADO



SECOND FLOOR

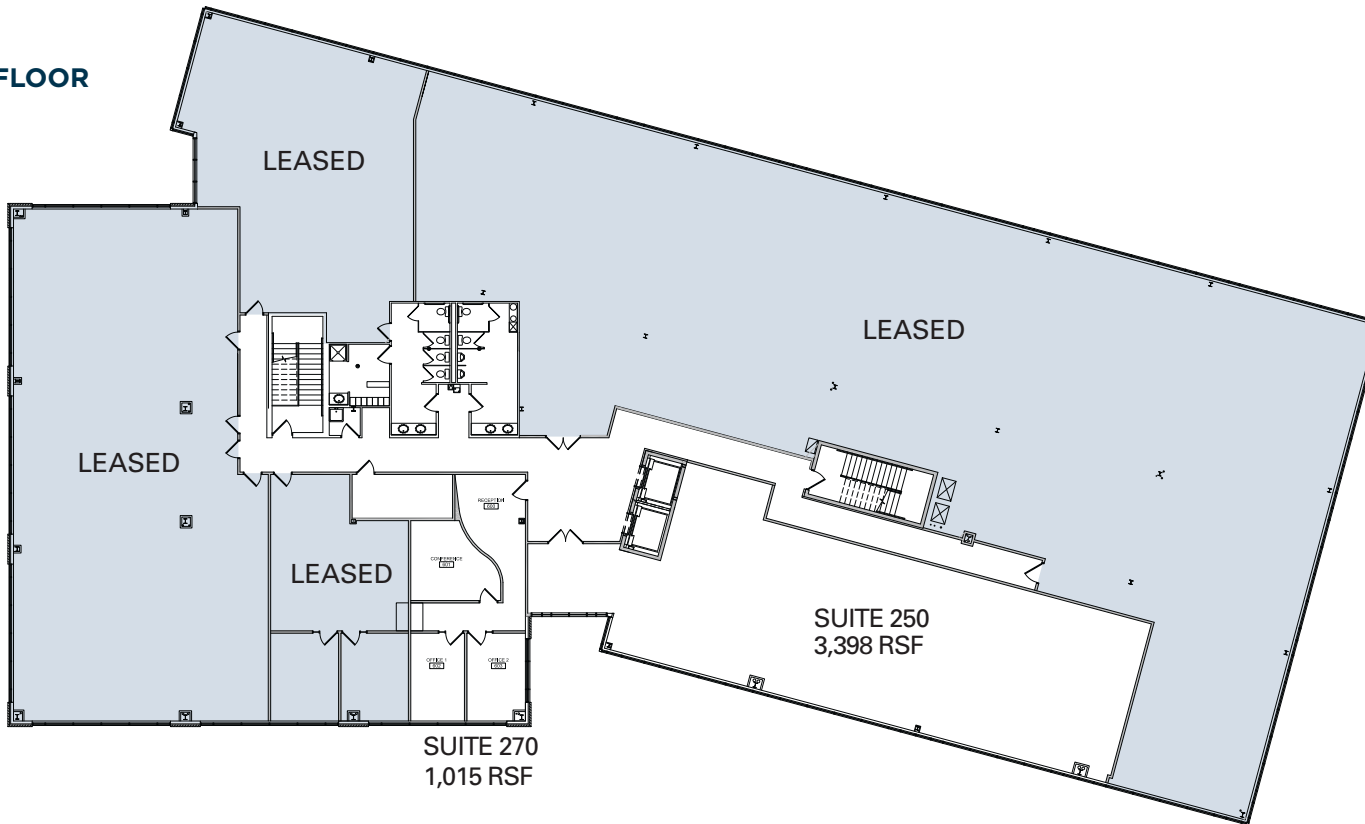

BUILDING HIGHLIGHTS

- LEED®—Certified Gold
- 1st generation Class A office space
- Unobstructed mountain views
- 4,413 RSF available, divisible to approx. 1,000 s.f.
- \$16.75 / s.f. NNN
- Perfect for office or medical users
- Approx. 4.25:1,000 SF of on-site parking
- Spec suites available now!

BUILDING LOCATION

- Close proximity to I-70 and I-270, 15 minutes to downtown Denver, 15 minutes to DIA
- Within walking distance to E. 29th Avenue Town Center, Quebec Square and Central Park

LEASING CONTACT



DON MISNER
303-217-7957
Don.Misner@am.jll.com

JOE HEATH
303-217-7959
Joe.Heath@am.jll.com